

Fish Eye View Garden _The Landscape That Fishes View

There was a time when one would open the newspaper only to see photos of dead fish in the Taehwagang River. At the time, the river was a body of foul and murky wastewater. Thanks to continued efforts over the last 20 years, Taehwagang River has transformed into the fresh river of life where salmon, otters, and a diversity of fish have returned. However, the story of this transformation has not been shared beyond the water itself. "Fish Eye View" is an artistic space that delivers the story of the fishes of the Taehwagang River through creative sculptures of the eight major fish species and the interpretive shelter that evokes their habitat. Taehwagang River is a ribbon of urban nature, where people and fish coexist.

LEGEND

- A. STONE CLIFF WALL
- B. STONE PLANTER
- C. RIVER ROCKS
- D. FISH SCULPTURE
- E. WATER PLANT SCULPTURE

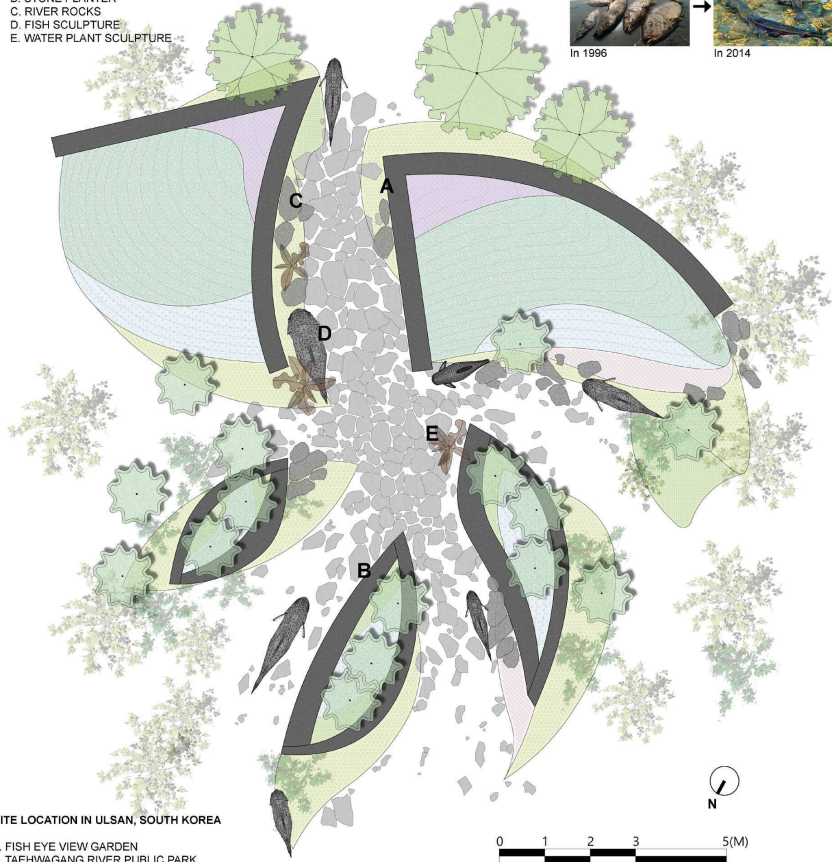

SITE LOCATION IN ULSAN, SOUTH KOREA

- 1. FISH EYE VIEW GARDEN
- 2. TAEHWAGANG RIVER PUBLIC PARK
- 3. TAEHWAGANG RIVER



Eight major fish species were selected out of 50 that have returned to Taehwagang River, recovered from the river of death to that of life, and we arranged the sculptures of each species sequentially throughout the garden as the highlight that gives a dynamic experience to visitors. To represent a part of the actual geography of Taehwagang River, a fish habitat was chosen and enlarged via a computational method to facilitate human-scale experiences. Particularly, rocks from the Taehwagang river cliff were used to visualize the fish's perspective on the underwater stratum and texture in the river and piling the rocks along the circular arc into layers to make the visual distortion intended to create a hemispherical image. Aquatic plants, underwater mosses, and other plants that remind a viewer of the underwater environment were selected from local plants and planted in the garden to complement with the forged sculptures of water plants.

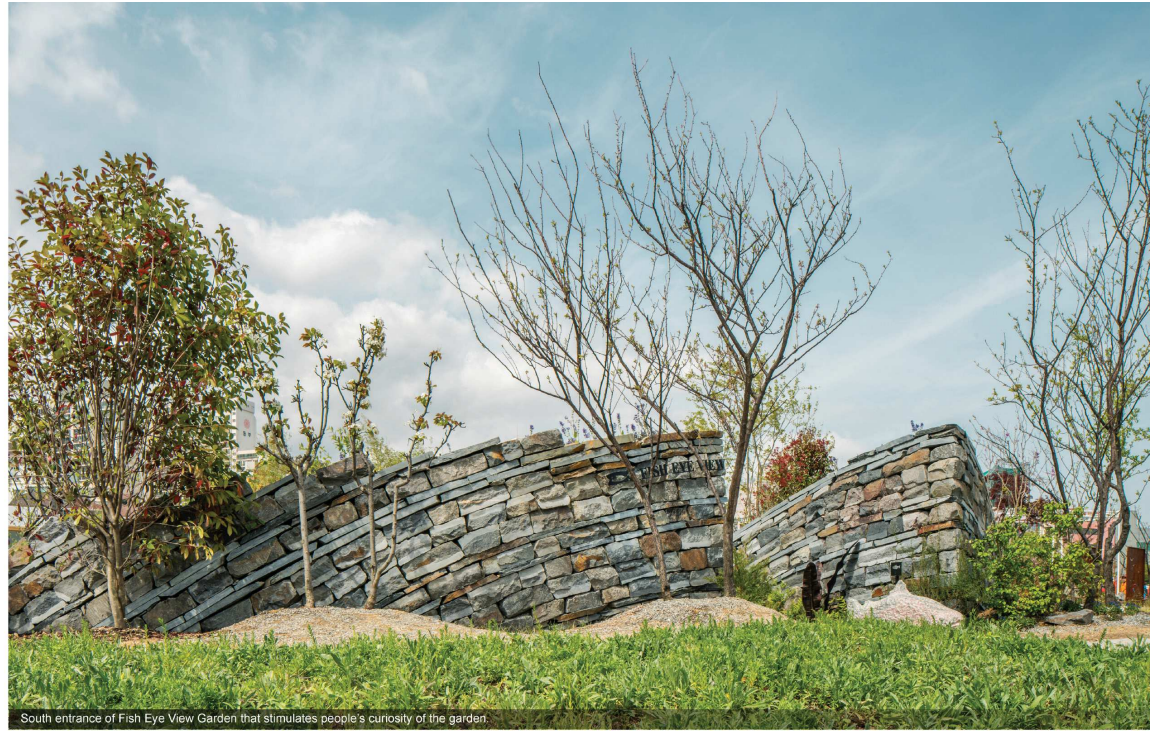

South entrance of Fish Eye View Garden that stimulates people's curiosity of the garden.

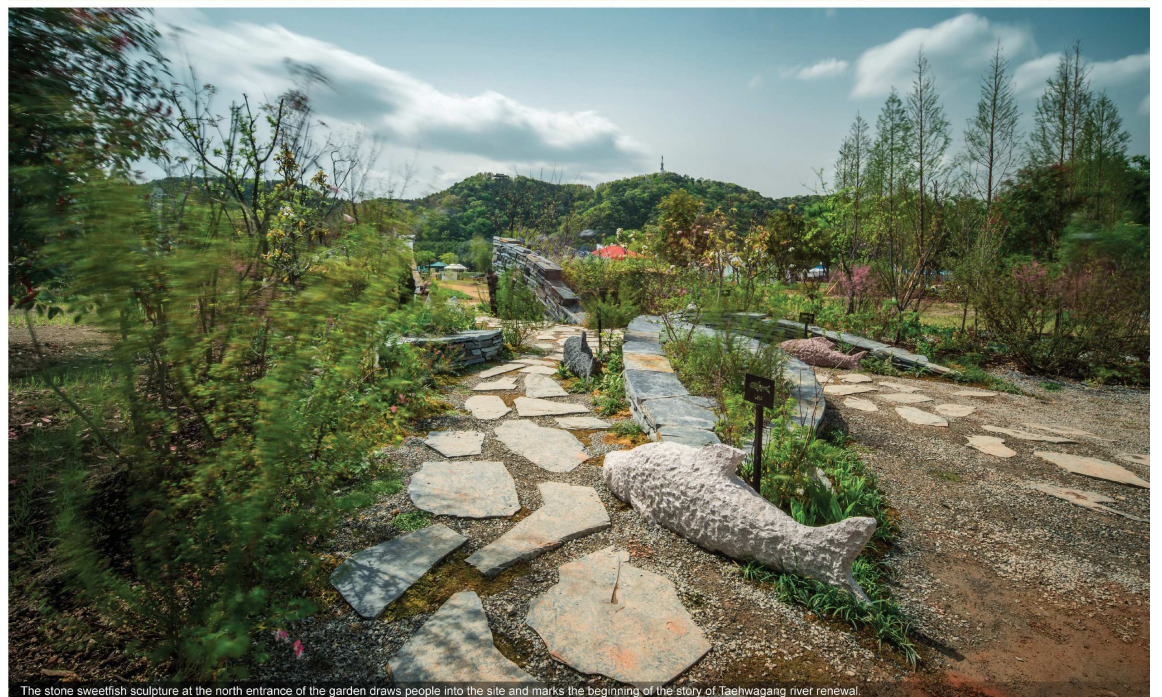

The stone sweetfish sculpture at the north entrance of the garden draws people into the site and marks the beginning of the story of Taehwagang river renewal.